

NOTES:-  
ALTHOUGH DUE CARE HAS BEEN TAKEN IN APPROVING THE BUILDING PLAN AS PER TECHNICAL NORMS, BUT THIS APPROVAL IS NOT PROVIDING ANY RIGHT TO YOU TO VIOLATE ANY RULE/GUIDELINES OF THIS DEPARTMENT OR ANY OTHER DEPARTMENT AND ALSO NOT PROVIDE ANY RIGHT FOR ANY ILLEGAL CONSTRUCTION. IN CASE ANY VIOLATION FOUND AT ANY STAGE, YOU SHALL BE LIABLE TO GET THE BUILDING PLAN REVISED ACCORDINGLY IMMEDIATELY.  
THE APPROVAL IS SUBJECT TO DECISION OF ANY COURT CASE PREVAILING IN ANY HONBLE COURT OF LAW, IF ANY."

THESE BUILDING PLANS ARE ISSUED  
VIA LETTER NO. EQ/GMADA/ DATED 11/01/2025  
3794

Technically Approved  
(From Town Planning Point of View)

Vide Letter No. 15  
DTP(S)/.....Dated. 02/10/2025

District Town Planner, S.A.S. Nagar

Estate Officer (H)  
GMADA, S.A.S. Nagar

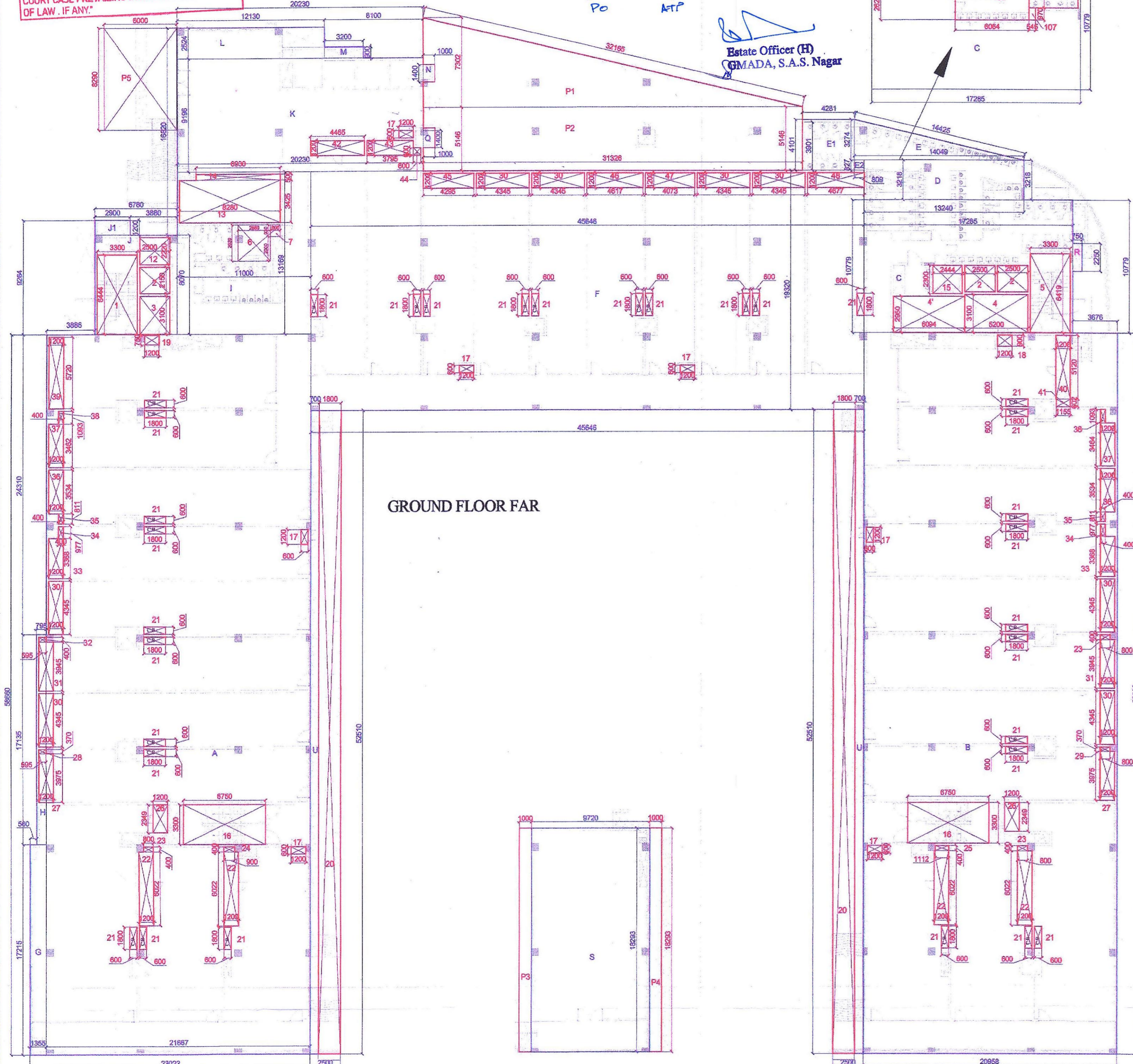

GROUND FLOOR FAR

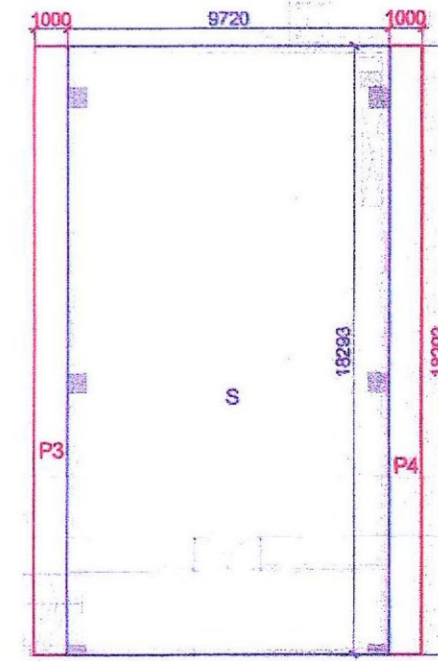

LOADING & UNLOADING AREA DETAIL

LOADING & UNLOADING CALCULATION AREA DETAIL	
GROUND FLOOR 1 <sup>ST</sup> FLOOR FAR DETAIL (3821.05+)	75.99.07
REQUIRED LOADING & UNLOADING AREA	50.26 M <sup>2</sup>
FAR 1000*2425 SQ.M @ PER BAY X 8	210 SQ.M
PROVIDED LOADING & UNLOADING AREA	210 SQ.M

GROUND FLOOR LOADING & UNLOADING AREA DETAIL					
S.N.O.	NO.	TYPE	BREATH	LENGTH	AREA IN SQ.M
A	1	RECTANGLE	35.646	5.900	210.311
TOTAL ADDITION					210.311
TOTAL G.F LOADING & UNLOADING AREA					210.311

GROUND FLOOR F.A.R. AREA					
S.N.O.	NO.	TYPE	BREATH	LENGTH	AREA IN SQ.M
A	1	RECTANGLE	21.67	58.66	1,270.99
B	1	RECTANGLE	20.96	58.66	1,229.40
C	1	RECTANGLE	17.29	10.78	186.32
D	1	RECTANGLE	13.24	3.22	42.61
E	0.5	TRIANGLE	14.05	3.27	22.97
E1	1	RECTANGLE	4.28	4.10	17.56
E2	1	RECTANGLE	0.81	0.83	0.67
F	1	RECTANGLE	45.65	19.32	881.88
G	1	RECTANGLE	1.36	17.22	23.33
H	1	RECTANGLE	0.80	17.14	13.62
I	1	RECTANGLE	11.00	13.17	144.86
J	1	RECTANGLE	6.78	8.07	54.71
J1	1	RECTANGLE	2.90	1.20	3.48
K	1	RECTANGLE	20.23	9.20	186.04
L	1	RECTANGLE	12.13	2.52	30.62
M	1	RECTANGLE	3.20	0.90	2.88
N	1	RECTANGLE	1.00	1.40	1.40
Q	1	RECTANGLE	1.00	1.40	1.40
R	1	RECTANGLE	0.75	2.25	1.69
S	1	RECTANGLE	9.72	18.29	177.81
U	2	RECTANGLE	2.50	52.51	262.55
TOTAL ADDITION					4,556.76

GROUND FLOOR NON F.A.R. AREA					
S.N.O.	NO.	TYPE	BREATH	LENGTH	AREA IN SQ.M
1	TOTAL T1				735.71
2	P1	TRIANGLE	31.33	7.5/2	114.37
3	P2	RECTANGLE	31.33	5.15	161.20
4	P3	RECTANGLE	1.00	18.29	18.29
5	P4	RECTANGLE	1.00	18.29	18.29
6	P5	RECTANGLE	6.00	8.29	49.74
TOTAL					1,097.61
DEDUCTIONS					
N	1	RECTANGLE	1.00	1.40	1.40
Q	1	RECTANGLE	1.00	1.40	1.40
TOTAL DEDUCTION					2.80
TOTAL GROUND FLOOR NON FAR					1,084.81

TOTAL GROUND FLOOR BUILTUP AREA 4,915.86

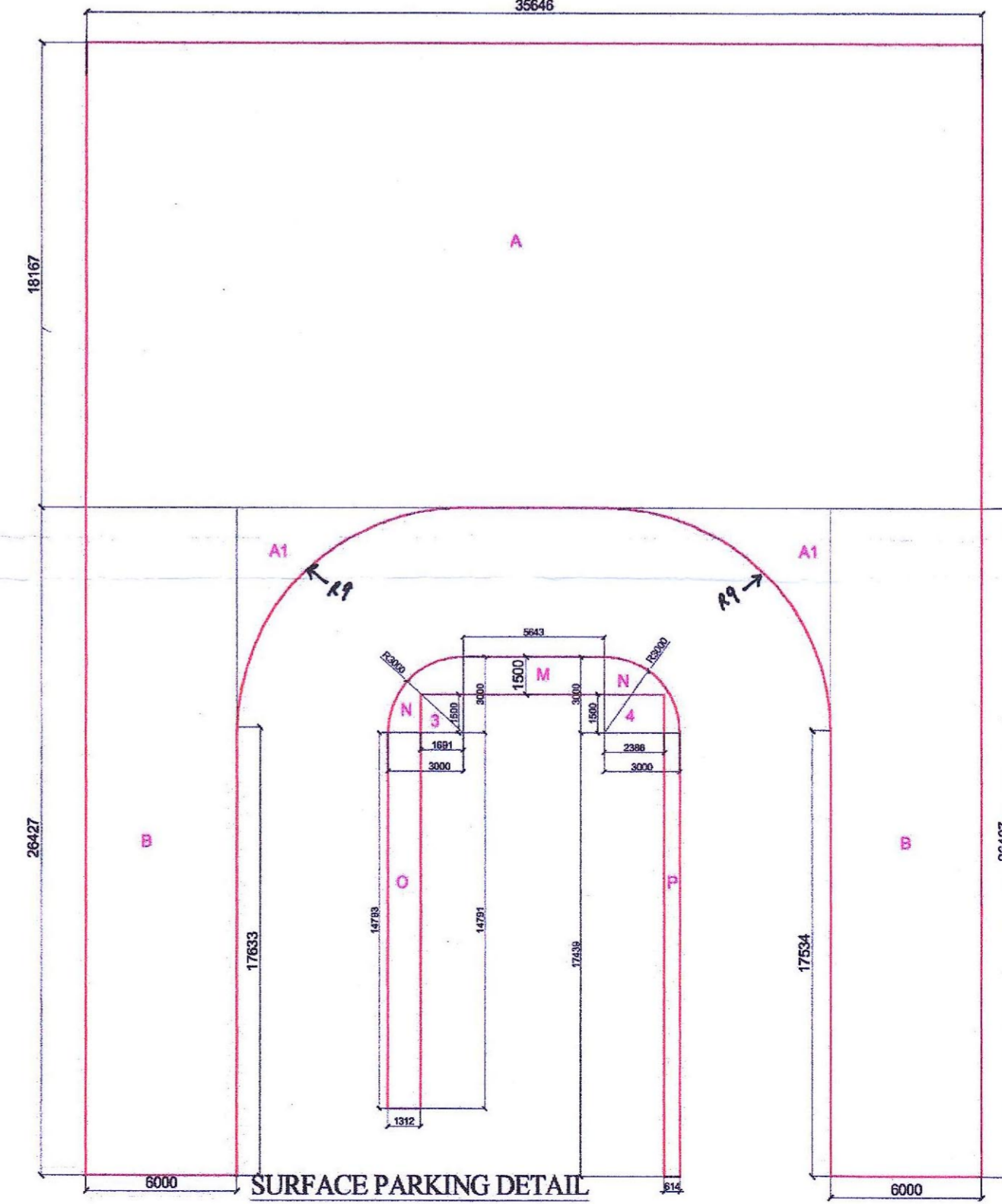
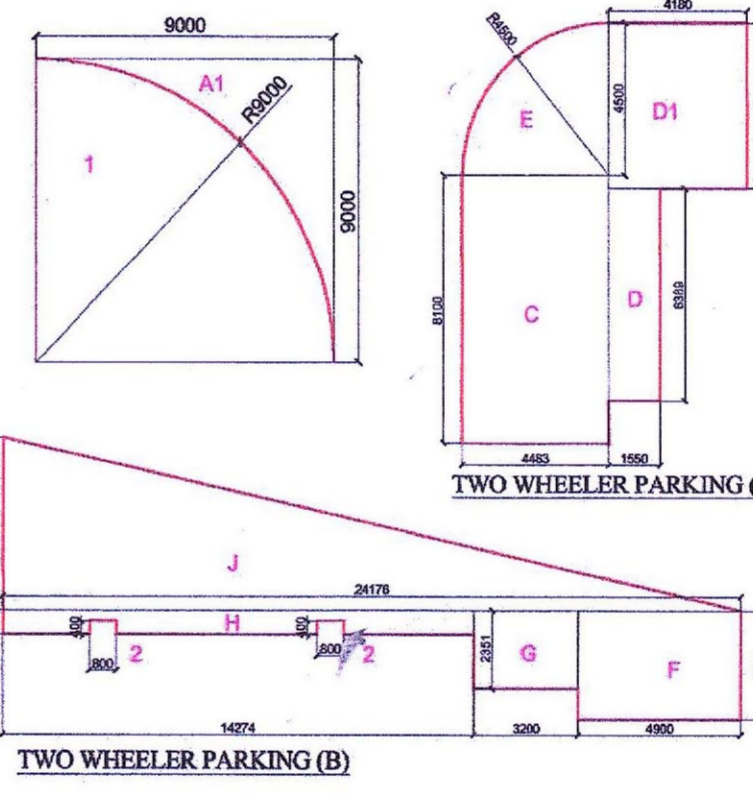

SUBTRACTIONS											
S.N.O.	NO.	TYPE	BREATH	LENGTH	AREA IN SQ.M	S.N.O.	NO.	TYPE	BREATH	LENGTH	AREA IN SQ.M
1	1	RECTANGLE	3.30	6.44	21.27	31	2	RECTANGLE	1.20	3.95	9.47
2	3	RECTANGLE	2.50	2.15	16.13	32	1	RECTANGLE	0.60	0.40	0.24
3	1	RECTANGLE	2.50	3.10	7.75	33	2	RECTANGLE	1.20	3.37	8.08
4	1	RECTANGLE	5.20	3.10	16.12	34	2	RECTANGLE	0.40	0.98	0.78
4'	1	RECTANGLE	6.09	2.95	17.98	35	2	RECTANGLE	0.40	0.81	0.65
5	1	RECTANGLE	3.30	6.42	21.18	36	2	RECTANGLE	1.20	3.53	8.48
6	1	RECTANGLE	2.68	2.92	7.83	37	2	RECTANGLE	1.20	3.46	8.31
7	1	RECTANGLE	0.80	0.93	0.74	38	2	RECTANGLE	0.40	1.09	0.87
12	1	RECTANGLE	2.50	2.22	5.55	40	1	RECTANGLE	1.20	5.12	6.14
13	1	RECTANGLE	8.28	3.43	28.36	41	1	RECTANGLE	1.16	0.60	0.70
14	1	RECTANGLE	6.93	0.50	3.47	42	1	RECTANGLE	4.47	1.20	5.36
15	1	RECTANGLE	2.44	2.30	5.62	43	1	RECTANGLE	3.80	1.20	4.55
16	2	RECTANGLE	6.75	3.30	44.55	44	1	RECTANGLE	0.60	0.60	0.36
17	7	RECTANGLE	1.20	0.60	5.04	45	1	RECTANGLE	4.30	1.20	5.15
18	1	RECTANGLE	1.20	0.90	1.08	46	1	RECTANGLE	4.62	1.20	5.54
19	1	RECTANGLE	1.20	0.75	0.90	47	1	RECTANGLE	4.07	1.20	4.89
20	2	RECTANGLE	1.80	52.51	49.40	48	1	RECTANGLE	4.68	1.20	5.61
21	32	RECTANGLE	1.80	0.60	34.56	101	1	RECTANGLE	3.93	3.90	15.32
22	4	RECTANGLE	1.20	6.02	28.91	102	1	RECTANGLE	0.81	1.90	1.54
23	3	RECTANGLE	0.80	0.40	0.96	103	0.5	TRIANGLE	13.24	2.99	19.73
24	1	RECTANGLE	0.90	0.40	0.36	104	1	RECTANGLE	12.81	5.54	70.96
25	1	RECTANGLE	1.11	0.40	0.44	105	1	RECTANGLE	6.06	2.62	15.89
26	2	RECTANGLE	1.20	2.35	5.64	106	1	RECTANGLE	4.05	3.96	16.02
27	2	RECTANGLE	1.20	3.98	9.54	107	1	RECTANGLE	0.55	0.97	0.53
28	1	RECTANGLE	0.60	0.37	0.22	TOTAL SUBTRACTION - T1					737.33
29	1	RECTANGLE	0.80	0.37	0.30	TOTAL GROUND FLOOR FAR					3819.43
30	8	RECTANGLE	1.20	4.35	41.71						

GROUND FLOOR SURFACE PARKING DETAIL					
S.N.O.	NO.	TYPE	BREATH	LENGTH	AREA IN SQ.M
A	1	RECTANGLE	35.646	18.167	647.581
A1	2	SQUARE	9.000	9.000	162.000
B	2	RECTANGLE	6.000	26.427	317.124
C	1	RECTANGLE	4.483	8.100	36.312
D	1	RECTANGLE	1.550	6.389	9.903
D1	1	RECTANGLE	4.180	4.880	20.398
QUADRENT					
E	1	CIRCLE	3.143	5.063	15.91
F	1	RECTANGLE	4.900	3.251	15.930
G	1	RECTANGLE	3.200	2.351	7.523
H	1	RECTANGLE	14.274	0.727	10.377
J	1	TRIANGLE	7.500	12.09	90.660
K	1	RECTANGLE	62.464	0.450	28.109
L	1	RECTANGLE	85.795	0.750	64.346
M	1	RECTANGLE	5.643	1.500	8.465
QUADRENT					
N	1	CIRCLE	3.143	2.250	7.07
O	1	RECTANGLE	1.312	14.791	19.406
P	1	RECTANGLE	0.614	17.439	10.708
Q	1	RECTANGLE	2.182	1.470	3.208
R	1	RECTANGLE	7.143	1.470	10.500
S	1	RECTANGLE	25.972	1.470	38.179
T	1	RECTANGLE	24.143	1.470	35.490
TOTAL ADDITION					1559.201
SUBTRACTIONS					
1	2	QUADRENT	3.143	20.250	127.29
2	2	RECTANGLE	0.800	0.400	0.640
3	1	RECTANGLE	1.691	1.500	2.537
4	1	RECTANGLE	2.386	1.500	3.579
TOTAL SUBTRACTIONS					134.041
TOTAL G.F SURFACE CAR PARKING AREA					1425.159
G.F SURFACE PARKING ECS @23 SQ.M					61.963
TOTAL NO'S OF SURFACE CAR PARKING					61.963

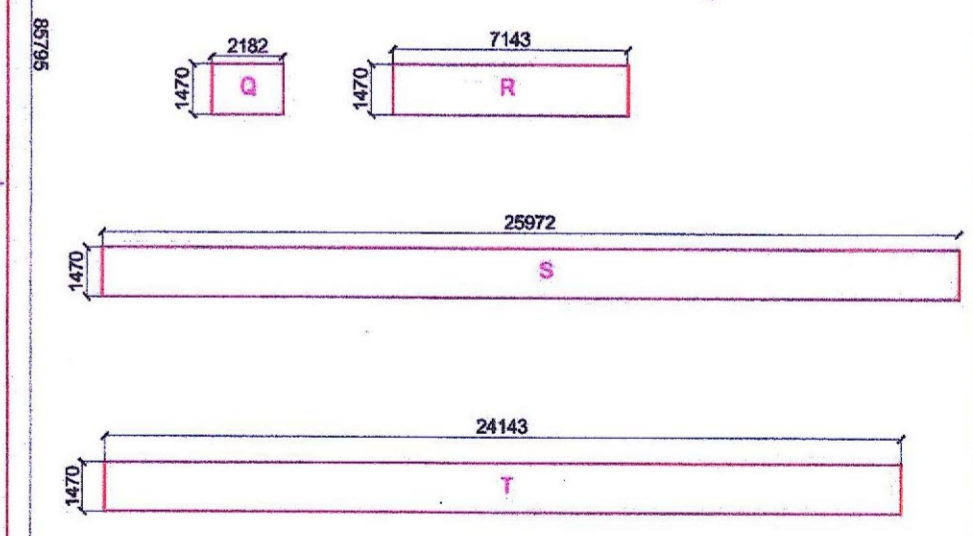

NOTE:-  
1. BUILDING IS FULLY SPRINKLERS AND FULLY MECHANICALLY VENTILATED ARTIFICIALLY LISTED WITH 100% POWER BACKUP AS PER NBC NORMS  
2. ALL RAILINGS ARE 1000MM IN HEIGHT.

CYBER SQUARE  
SITE NO 1 & II SHOPPING COMPLEX  
PHASE -IX EXPANSION INDUSTRIAL  
FOCAL POINT SAS NAGAR MOHALI

OWNERS SIGNATURE: [Signature]  
ARCHITECT'S SIGNATURE: [Signature]  
DRAWING TITLE: GROUND FLOOR FAR DETAIL SHEET  
DATE: 28.12.2024  
DRAWING NUMBER: A-10  
SCALE: 1:200